

GENERAL NOTES

ALL WORK TO BE CARRIED OUT IN STRICT ACCORDANCE WITH THE CURRENT BUILDING REGULATIONS AND ITS LATEST AMENDMENTS, AND TO THE COMPLETE SATISFACTION OF THE LOCAL AUTHORITIES BUILDING CONTROL.

CONTRACTORS ARE RESPONSIBLE FOR COMPLYING WITH ALL RELEVANT BS ETC., AND CHECK THAT BUILDING CONTROL AND ENVIRONMENTAL HEALTH DEPARTMENTS ARE SATISFIED WITH THE SCOPE AND CONTENT OF ALL WORK ON COMPLETION AND OBTAIN ANY NECESSARY CERTIFICATES.

ALL EXISTING CONSTRUCTION LEVELS AND DIMENSIONS TO BE CHECKED PRIOR TO CONSTRUCTION, ESPECIALLY WHERE NEW CONSTRUCTION LEVELS AND DIMENSIONS ARE TO MATCH EXISTING.

ALL SITE DIMENSIONS AND SITE LEVELS MUST BE CHECKED ON SITE. PLEASE CONTACT THE ARCHITECT SHOULD THERE BE ANY SIGNIFICANT DISCREPANCIES IN ANY DIMENSIONS.

THIS DRAWING MUST NOT BE USED FOR CONSTRUCTION UNLESS ISSUED FOR CONSTRUCTION.

THIS DRAWING SHOULD BE READ IN CONJUNCTION WITH ALL RELEVANT ENGINEERS AND SPECIALIST DRAWINGS.

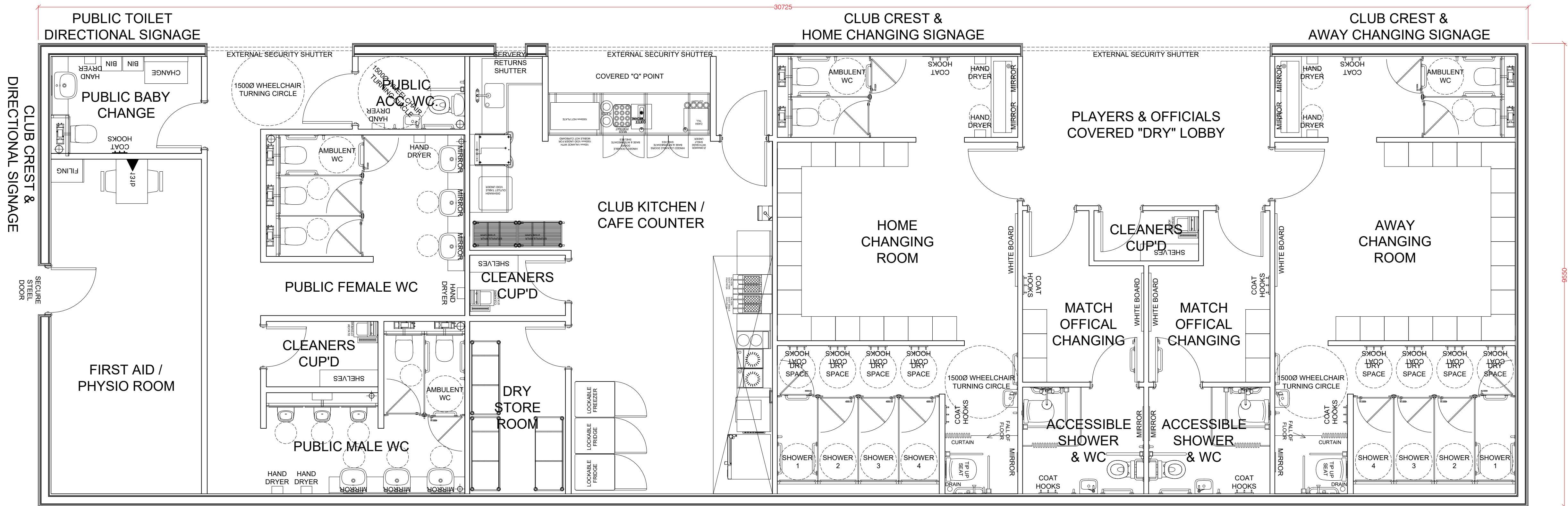

E	10.06.25	MINOR EDIT - REMOVE "CONSULTATION ROOM" FROM PHYSIOFIRST AID ROOM. COAT HOOKS ADDED TO OFFICIAL'S SHOWER ROOM.	VG	LN
D	09.06.25	EDITS REQUIRED FROM CLIENT - ALL FACILITIES TO BE ACCESSED FROM PITCH SIDE. CHANGING FACILITIES INCREASED IN SIZE TO MEET CLUB GRADING SPECIFICATIONS.	VG	LN
C	13.05.25	CLIENT MOVED AWAY FROM PORTAKABIN LAYOUTS AND INTO PURPOSE BUILT STRUCTURE. FIRST ISSUE OF NEW CHANGING & PUBLIC FACILITIES - SINGLE STOREY WITH ADDITIONAL PARKING.	VG	LN
B	10.06.24	TWO CHANGING VILLAGE OPTIONS RE-ISSUED BACK TO THE CLIENT WITH THE PORTAKABIN ARRANGEMENT MORE CENTRAL TO THE END OF THE 5G PITCH. OPT 2 RAISED ONTO INFILL AND OPT 3 SET AT PITCH LEVEL (OUT AWAY).	VG	LN
A	24.04.23	OPTION 1 PREFERRED - LAYOUT OPTION EDITED AND RE-ISSUED BACK TO CLIENT FOLLOWING RECEIPT OF COMMENTS/FEEDBACK.	VG	LN
	24.04.23	FIRST ISSUE - ISSUED TO THE CLIENT FOR INITIAL COMMENTS AND FEEDBACK - DRAFT OPTS 1 & 2 FOR TWO STOREY CLUBHOUSE OPTIONS.	VG	LN
REV	DATE	DESCRIPTION	DR	CHK

**PRELIMINARY ISSUE**

**KLE**DESIGN  
ARCHITECTURE | PLANNING | VISUALISATIONS

CLIENT		
AYLESFORD FOOTBALL CLUB		
PROJECT		
AYLESFORD FC, FORSTAL ROAD, ME20 7AU PROPOSED CHANGING & PUBLIC FACILITIES		
DRAWING		
GENERAL ARRANGEMENT PROPOSED CLUB CHANGING & PUBLIC FACILITIES		
SCALE @ A1	DRAWN	CHECKED
1:50	VG	LN
CREATION DATE	REVISION	
APRIL 2023	E	
KLEDESIGN DRAWING NO.		
K1263 - KLE - ME20 - 00 - DR - A - 100		
PROJECT NO COMPANY NAME EXIST TYPE ROLE NUMBER		

© COPYRIGHT - ALL RIGHTS RESERVED.

- THIS DRAWING MUST NOT BE REPRODUCED WITHOUT PERMISSION.

- THIS DRAWING MUST BE READ IN CONJUNCTION WITH ALL RELEVANT CONSULTANT / SPECIALIST DRAWINGS / INFORMATION.

- THIS DRAWING MUST NOT BE USED FOR CONSTRUCTION UNLESS ISSUED FOR CONSTRUCTION.

- ALL DIMENSIONS ON THIS DRAWING ARE IN MILLIMETERS (UNLESS OTHERWISE STATED).

- ANY DISCREPANCIES MUST BE REPORTED TO KLEDESIGN IMMEDIATELY.

- DO NOT SCALE OFF DRAWINGS USE DISPLAYED DIMENSIONS ONLY.